

BPA-MP

Multi-tracks bottom sealed bags

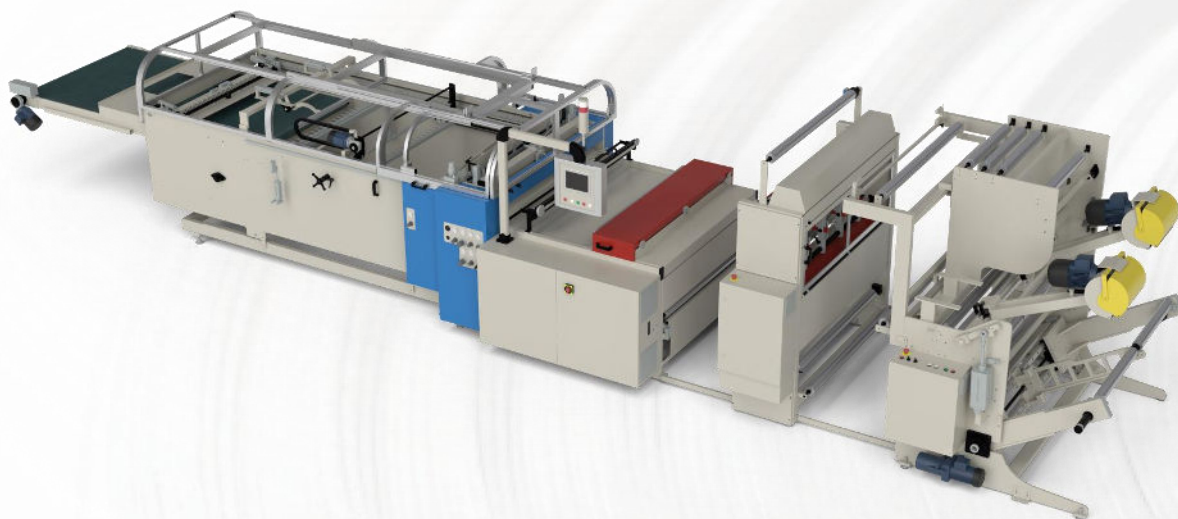

The bag-making machine model BPA-MP is designed for the production of **small and medium bottom-sealed bags**, high-speed operation, multi-lane system by cutting/sealing blades, brushless servo-driven synchronization and tension control, complete with reel stand (shafted or shaftless) with hydraulic lifting. Bags stacking by double needle-free clamping system, complete with gripper collecting table and programmable accumulation conveyor.

Bottom sealed bag



Gusseted and bottom sealed bag



TECHNICAL CHARACTERISTICS

Technical Data	Size 1140	Size 1340	Size 1640
Maximum cycles per minute	180	180	180
Maximum tracks number	5	9	9
Maximum linear speed	160 m/min	160 m/min	160 m/min
Minimum material thickness	2 x 6 µm	2 x 6 µm	2 x 6 µm
Maximum material thickness	4 x 100 2 µm	4 x 100 2 µm	4 x 100 2 µm
Minimum bag length	180 mm	180 mm	180 mm
Maximum bag length	2000 mm	2000 mm	2000 mm
Folds	2/4	2/4	2/4
Type of materials	LDPE, HDPE		

MACHINE LAYOUT

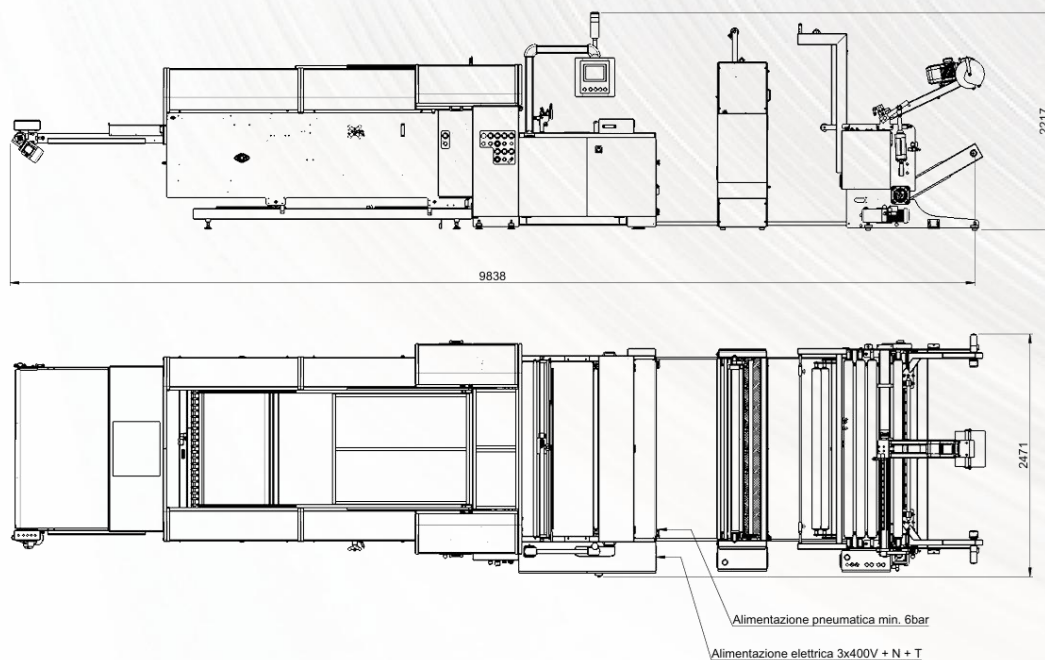

In.Pack Machinery Srl reserves the right to modify the content of this flyer at its sole discretion and without prior notice. All rights reserved.