

# E-COM 1

## LINE SPECIFICATIONS

|  |                    |              |
|--|--------------------|--------------|
| Drum width                                 | 520 mm             | 20.47"       |
| Max. paper width                           | up to 1300 mm      | up to 51.18" |
| Max. production speed                      | up to 250 bags/min |              |
| Bag making machine height (A)              | 2300 mm            | 90.55"       |
| Bag making machine width (B)               | 2500 mm            | 98.42"       |
| Bag making machine length (C)              | 5935 mm            | 233.66"      |
| Full line length with optional devices (D) | 18 790 mm          | 739.76"      |

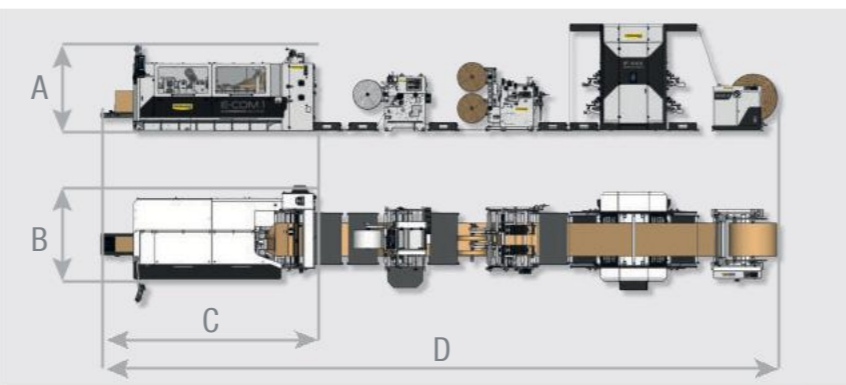

## LINE EQUIPMENT

Strip unit



Paper Tear Tape

Flexographic printer



## BAG SPECIFICATIONS & OPTIONS

|                |  |                 |
|----------------|--|-----------------|
| Bag width      | 90 mm - 480 mm                             | 3.54" - 18.89"  |
| Cutting length | 320 mm - 760 mm                            | 12.59" - 29.92" |
| Gusset depth   | 12 mm - 80 mm                              | 0.47" - 3.14"   |
| Flap height    | up to 100 mm                               | up to 3.93"     |
| Paper weight   | 70 g/m <sup>2</sup> - 140 g/m <sup>2</sup> |                 |



Single Release strip



Ship & return Release strips



Extended Release strip



Ship & return Extended release strip



Single release strip Wicket holes



Ship & return Wicket holes



Extended release Extended release strip Wicket holes



Ship & return Extended release strips Wicket holes

## E-Com1 Video

Scan QR code :



**REPAKT** Paper Division

**Holweg**

**Weber**

**MDM**

www.holwegweber.com

### SALES CONTACT:

- North America  
+1 920 894 2221 - info@holwegweber.com
- Europe  
+33 3 88 47 84 84 - holweg@holweg.fr
- Asia-Pacific  
+86 20 3485 5787 / 5189 / 5797



www.repakt.com

## E-COMMERCE SOLUTIONS

**Holweg**

a Brand of REPAKT

## INNOVATIVE AND SUSTAINABLE SOLUTION FOR E-COMMERCE

The packaging produced by the E-Com1 is biodegradable, reduces void space, and has a ship and return feature, which allows for reliable use and reuse. Thus, making this machine a solution that truly addresses the current environmental challenges facing the packaging industry.

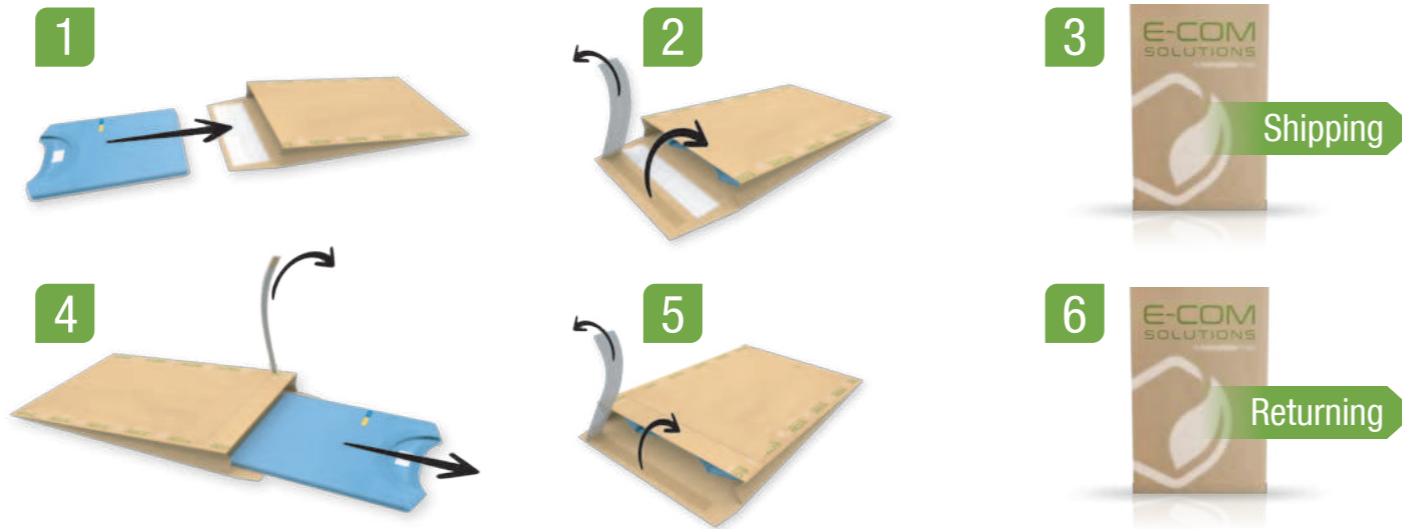
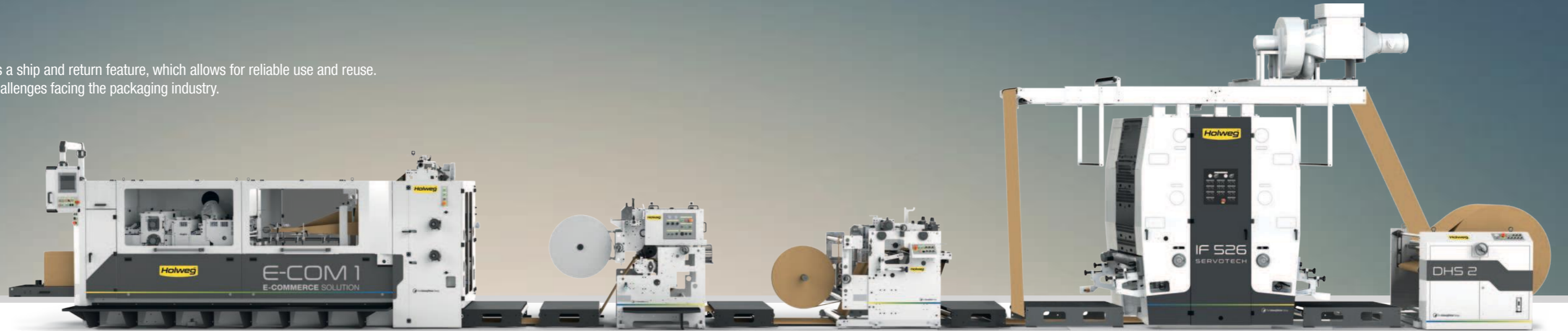

### FRUSTRATION-FREE E-COM PACKAGING

The “Ship & Return” mailer bag has a unique gusset feature that provides the flexibility one needs to send out a variety of goods purchased online. In addition to this unique feature, the mailer bag also has a two-seal system that makes sending and returning goods easy and reliable.

How it Works:

- 1- Put an item into the mailer bag
- 2- Close the bag with the first strip
- 3- Send the bag out with the item inside
- 4- Easily remove the hassle-free seal
- 5- Put the item back in and reseal
- 6- Return the bag with the item sealed safely inside

### MAXIMIZED OEE

Each device that makes up the HolwegWeber E-Com1 production line is equipped with reliable components, developed for easy setup, and an advanced ergonomic design which enables the operator to make change overs more efficiently, and maximizing the Overall Equipment Effectiveness.

